

# EHTPE\* miniature accelerometer

## Model 2278-1

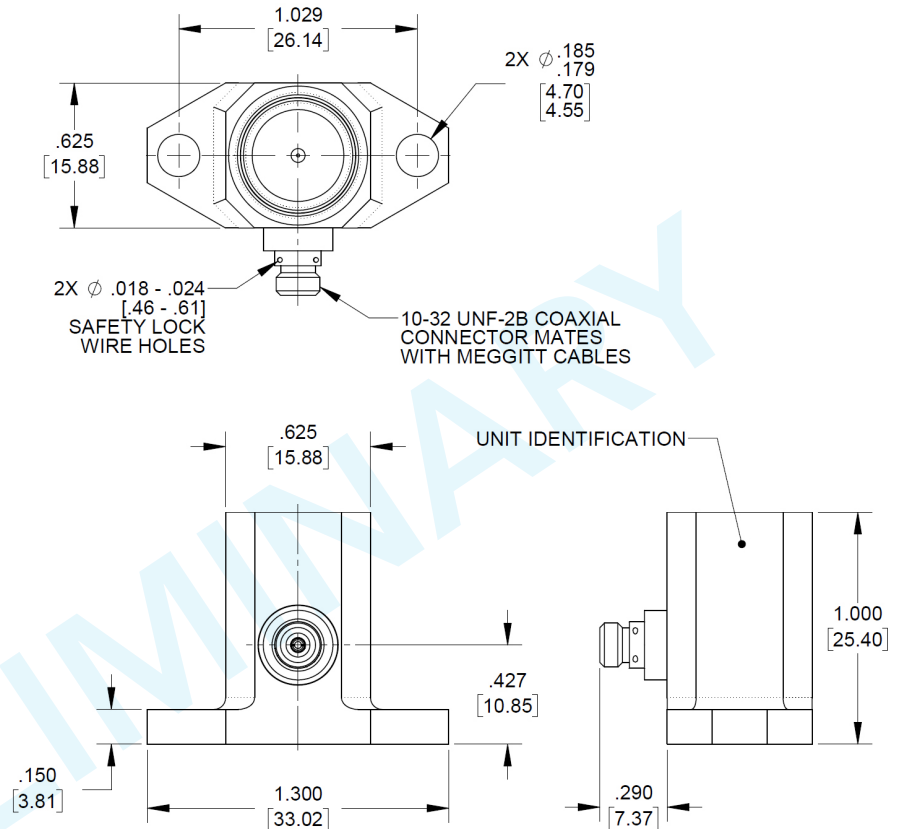
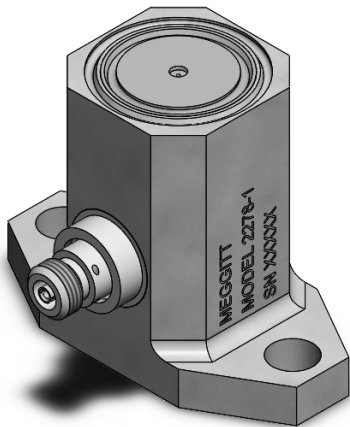

\* Extreme High Temperature Piezoelectric

### Key features

- Operating up to +1200°F (+650°C)
- Small and lightweight (48g), single axis
- Ground isolated
- Fully compliant to EU technical regulations and RoHS

### Description

The MEGGITT Model 2278-1 is a small, lightweight piezoelectric single axis accelerometer for shock and vibration measurements at temperatures up to 1200°F. It is also capable of operation in nuclear environments. This accelerometer is 1.0 inch [25.4] tall and weighs 48 grams. It features a side 10-32 receptacle and has a flange with two 8-32 holes for mounting. The 2278-1 features MEGGITT Proprietary MC2 sensing element and is designed for use with high temperature. Coaxial cables such as the hardline 3075M6 (rated to 900°F) or flexible 3076 (rated to 1000°F) or the 3076A (rated to 1200°F) are designed for use with the 2278-1.

# EHTPE\* miniature accelerometer

## Model 2278-1

### Specifications

All values are typical at +75°F (+24°C), referenced at 100 Hz and conform to ISA-RP 37.2 unless otherwise specified.

Dynamic characteristics	Units	
Charge sensitivity		
Typical	pC/g	4.0
Tolerance	pC/g	± .5
Frequency response		
Resonance Frequency		
Typical	kHz	20
Minimum	kHz	18
Typical Amplitude Response		
± 5%	Hz	1 to 4000
± 10%	Hz	1 to 5000
± 3dB	Hz	1 to 6000
Temperature response		
Over temperature range	%	+15
Transverse sensitivity	%	≤ 5
Amplitude linearity	%	1
Per 500 g, 0 to 2000 g		
<b>Electrical characteristics</b>		
Resistance		
Over temperature range	kΩ	≥ 10
Isolation		
Over temperature range	kΩ	≥ 500
Capacitance	pF	50
Grounding		Signal return isolated from case
<b>Environmental characteristics</b>		
Temperature range		(-67°F to +1200°F) -55°C to +650°C
Humidity		Hermetic
Sinusoidal vibration limit	g	500
Shock limit	g	2000
Radiation		5 x 10 <sup>7</sup> rad per IEEE STD 383-1974
<b>Physical characteristics</b>		
Weight	gm (oz)	48 [1.7]
Case material		Inconel
Mounting	Qty 2	8-32 X 1/2 inch, Inconel socket head screw
Recommended Torque	lbf-in (Nm)	18-20 (2-2.3)
<b>Calibration</b>		
Supplied		
Charge sensitivity	pC/g	
Frequency response	%	±5, 50 Hz to 4000 Hz
Transverse sensitivity	%	
Capacitance	pF	

# EHTPE\* miniature accelerometer

## Model 2278-1

### Accessories

Product	Description	2778-1
EH873, 2X	Mounting Screw, 8-32 X 1/2 in, socket head, Inconel	Included
MEGGITT Model 3076A-120	Cable Assembly (1200°F)	Optional
MEGGITT Model 3076-120	Cable Assembly (1000°F)	Optional
MEGGITT Model 3075M6-120	Cable Assembly (900°F)	Optional
MEGGITT Model 1772-5	Remote charge converter – extended frequency range	Optional
MEGGITT Model 33268	In-line adaptor (connects cables)	Optional

### Notes

1. Frequency response is controlled by the resonance characteristics of the transducer. Estimated calibration errors are  $\pm 1.5\%$  to 900 Hz and  $2.5\%$  from 900 Hz to 5000 Hz.
2. Low-end response of the transducer is a function of its associated electronics.
3. CE Certification: This product is fully compliant to the European Union's Low Voltage Directive 2006/95/EC, EMC Directive 2004/108/EC, and compliant RoHS Directive 2002/95/EC, and is eligible to bear the CE Mark.

PRELIMINARY



Continued product improvement necessitates that Meggitt reserve the right to modify these specifications without notice. Meggitt maintains a program of constant surveillance over all products to ensure a high level of reliability. This program includes attention to reliability factors during product design, the support of stringent Quality Control requirements, and compulsory corrective action procedures. 041320

APPLIES TO CALIFORNIA FACILITY